

Subject: RE: Austral West Roundabout At Road 2 and 16
Date: Friday, 21 April 2023 at 12:21:06 pm Australian Eastern Standard Time
From: Andy Yung
To: Matt Cooper
CC: SBoukatos@landcom.nsw.gov.au, John Drivas
Attachments: image005.png, image004.jpg, image003.png, image002.png

Matt,

Thanks for your email below. Here is a summary of the advice I provided previously and the added commentary in dot points 4 and 5:

- This intersection (Road 02 | Road 16) was not identified in the Addendum Post-Exhibition Traffic Report (AECOM) that it needs to be upgraded to a roundabout or traffic signals.
- This intersection was not identified in the Liverpool Contributions Plan 2014 Austral and Leppington North Precincts that it needs to be upgraded to a roundabout or traffic signals.
- This intersection is at the junction of a local street and a shared street hence with relatively low volumes of local traffic, hence would not trigger the need for a roundabout or traffic signals.
- Since Road 16 and Road 06 are local streets and not meant to carry through traffic and operate as collector streets, the amount of traffic that would be expected to be turning into and out of Road 06 and Road 16 onto Road 02 is limited to those generated by the dwellings on Road 06 and Road 16. Hence the other reason that a roundabout is not warranted to manage the turning traffic at this intersection.
- Road 16 also does not extend further south of Lapwing Street hence does not draw any additional traffic from the rest of the precinct and therefore is expected to have very low traffic volume.
- Hence it would just be configured as a conventional give-way intersection, with give-way signs and linemarking on the northern and southern approaches of Road 06 and Road 16 respectively, as shown in sketch below.

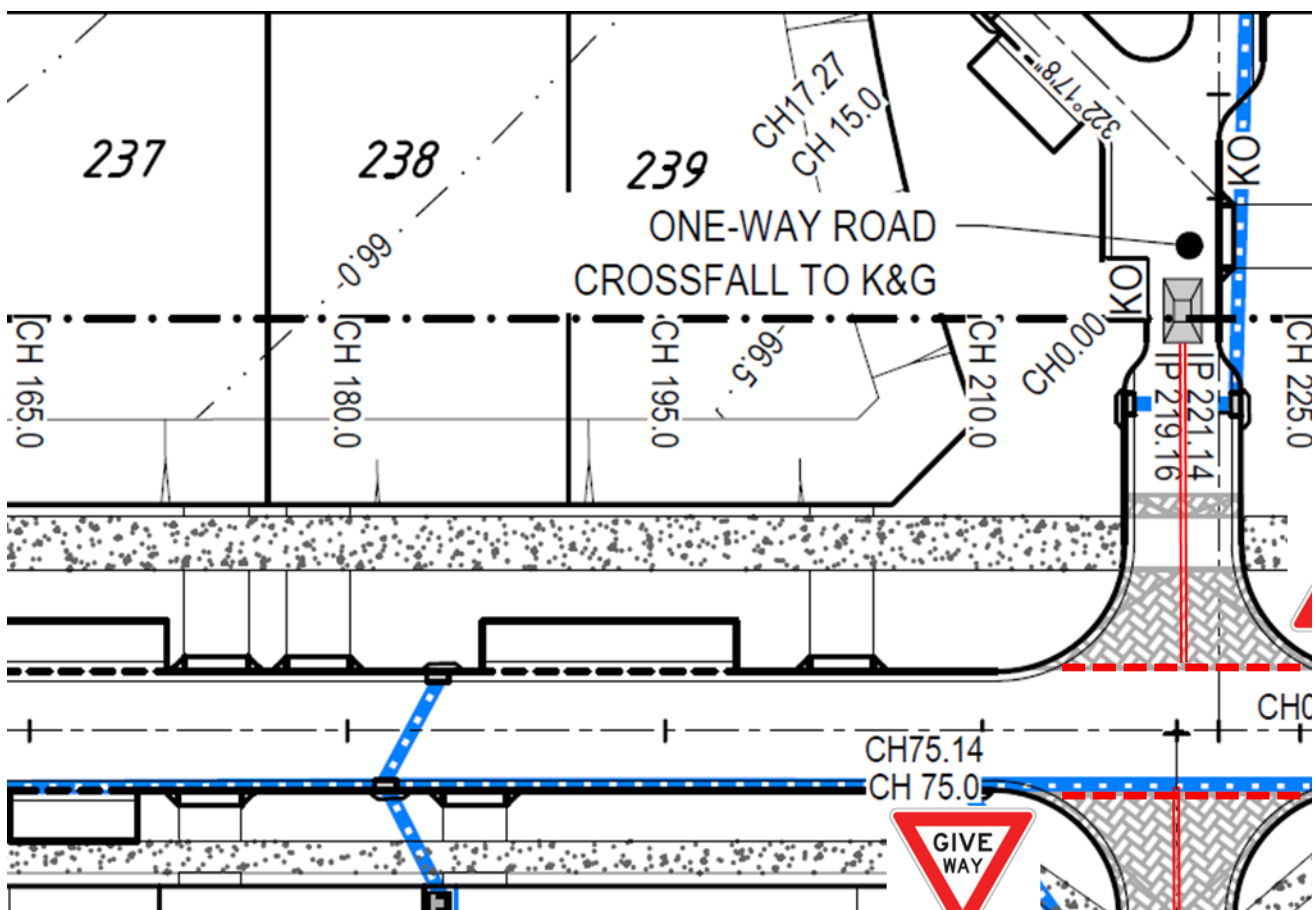

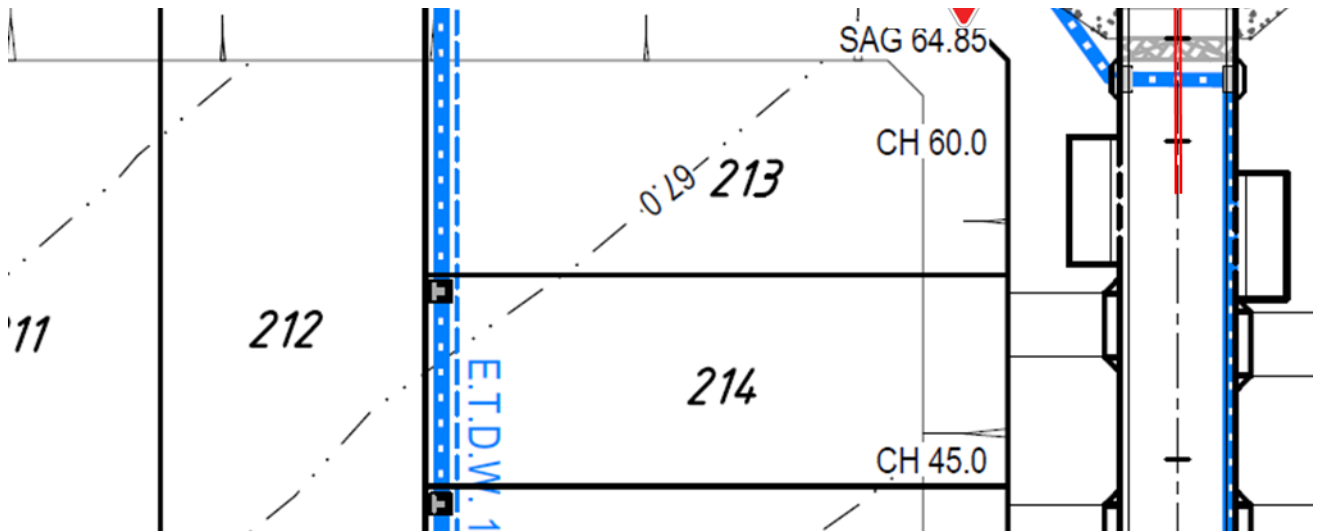

Andy Yung
DIRECTOR

andy.yung@sctconsulting.com.au | 0468 862 482
Suite 4.03, Level 4, 157 Walker Street, North Sydney NSW 2060



Thoughtful transport solutions | sctconsulting.com.au | [LinkedIn](#)



SCT Consulting acknowledges the traditional owners of the lands on which we work.
We pay our respects to Elders past, present and emerging.

[Disclaimer](#)

From: Matt Cooper <Matt@glplanning.com.au>
Sent: Friday, April 21, 2023 12:01 PM
To: Andy Yung <andy.yung@sctconsulting.com.au>
Cc: SBoukatos@landcom.nsw.gov.au; John Drivas <jdrivas@landcom.nsw.gov.au>
Subject: Austral West Roundabout At Road 2 and 16

Hi Andy,

Trust you've been keeping well.

Steven, John and I caught up with DPE PDU and FPD today to run through commentary on the final report positions and conditions for Austral West (DA-1295/2021) and Austral East 9DA-1298/2021). We had a bit of discussion on the requirements from Council to investigate the design requirements for a roundabout at the intersection at Road 2 and 16 in the Austral West DA. You've previously provided commentary regarding there not being a warrant for this intersection as well as a mock up of the 'Give Way' signage controlled intersection arrangements that are fit for purpose. To assist FPD in finalising their report, I'm hoping you can reattach that advice in response to this email.

Since you provided this advice, Council has agreed that the development does not warrant the installation of an intersection however has still requested that Landcom carry out the design of the intersection should it be

required in the future. Given both Landcom and Council are in agreement that the roundabout does not warrant the installation of the intersection, Landcom does not want to have to unnecessarily undertake design works. In this vein, in responding to this email, are you able to also include advice/commentary regarding the likelihood or need a roundabout at the intersection of Road 2 and 16. Presumably, the desire lines of traffic from development of the south, in partnership with the 'Give Way' intersection arrangement would more likely direct traffic to the south to the major trip generating activities (i.e journey to work, school, recreation activity, shopping etc). Where development of the south did generate trips that might go to the north, presumably the collector road would serve that purpose.

We are under quite the time pressure to provide this advice to assist FPD in finalising their reports to the Sydney Western City Planning Panel to meet the deadline for determination on 1 May, which requires FPD to finish their report on 24 April. Is this advice able to be prepared today?

Happy to talk through when you have a minute.

Matt Cooper
Director



A Level 10, 70 Pitt Street Sydney NSW 2000
P GPO Box 5013 Sydney NSW 2001
M 0422 979 955
T (02) 9249 4100
F (02) 9249 4111
W glnplanning.com.au